

EROSION AND SEDIMENT CONTROL

- SILT CONTROL FENCE SHALL BE INSTALLED AROUND THE PERIMETER OFFSET 0.60M INSIDE THE PROPERTY OF THE SITE AND MAINTAINED UNTIL THE COMPLETION OF THE LANDSCAPING.
- DURING GRADING OPERATIONS, ALL STORM RUNOFF SHALL BE CONTROLLED WITH TEMPORARY SWALES TO PREVENT SURFACE RUNOFF FROM LEAVING THE SITE UNTREATED.
- MUD MAT FOR CONSTRUCTION ACCESS IS TO BE INSTALLED AT ALL SITE ENTRANCES PRIOR TO THE STRIPPING OF TOPSOIL AND IS TO BE MAINTAINED UNTIL ROADS/DRIVEWAYS HAVE BEEN CONSTRUCTED TO BASE COURSE ASPHALT. MUD MAT TO BE A MINIMUM 30M LONG AND 8M WIDE AND SHALL CONSIST OF 100MM CLEAR STONE AND 450MM DEEP.
- VEHICLE REFUELLING AND SOIL STOCKPILING SHALL BE UNDERTAKEN AWAY FROM ANY VALLEY/WATERCOURSE OR EXISTING CATCHBASINS.
- ADDITIONAL EROSION AND SEDIMENT CONTROL MATERIALS (i.e. SILT FENCE, STRAW BALES, CLEAR STONE, ETC.) ARE TO BE KEPT ON SITE FOR EMERGENCIES AND REPAIRS.
- EROSION AND SEDIMENT CONTROL MEASURES ARE TO BE CONTINUOUSLY EVALUATED AND REPLACED/MAINTAINED AS REQUIRED TO ENSURE THEIR EFFECTIVENESS.
- ALL CATCHBASINS ARE TO BE PROTECTED WITH SEDIMENT TRAPS AS PER DETAIL ON ESC2 IMMEDIATELY AFTER INSTALLATION AND ARE TO BE MAINTAINED UNTIL ALL CONSTRUCTION IS COMPLETE.
- ALL TOPSOIL STOCKPILES INTENDED TO REMAIN IN PLACE FOR MORE THAN 30 DAYS ARE TO BE SEEDED TO PREVENT WIND EROSION.
- THE CONTRACTOR MUST UNDERTAKE MEASURES TO CONTROL DUST DURING CONSTRUCTION, AND DURING SOIL REMEDIATION/EXCAVATION ACTIVITIES, AND SHOULD INCLUDE THE FOLLOWING AS APPLICABLE:
 - THE WEEKLY, OR MORE FREQUENTLY IF REQUIRED, WETTING OF ALL SOFT AND HARD SURFACES AND ANY EXCAVATION FACE ON THE SITE, WITH THE ADDITION OF CALCIUM CHLORIDE OR OTHER RECOGNIZED MATERIALS AS A DUST SUPPRESSANT, IF REQUIRED;
 - THE WEEKLY CLEANING OF THE ROAD PAVEMENT AND SIDEWALKS FOR THE ENTIRE FRONTAGE(S) OF THE PROPERTY TO A DISTANCE OF TWENTY-FIVE METRES FROM THE PROPERTY LINES.
- SINCE THE LOCATION AND TYPE OF EROSION AND SEDIMENT CONTROL MEASURES WILL BE MODIFIED AS THE CONSTRUCTION OF THE SITE PROCEEDS, EROSION AND SEDIMENT CONTROL, BEST MANAGEMENT PRACTICES ARE DYNAMIC AND ADJUSTMENTS TO THE LOCATION AND TYPE OF ESC MEASURES WILL BE REQUIRED TO REDUCE THE AMOUNT OF SEDIMENT LEAVING THE SITE AND ONTO ADJACENT AREAS.
- BEFORE PROCEEDING WITH ANY AREA GRADING THE FOLLOWING MUST BE CONSTRUCTED:
 - MUD MAT WHERE INDICATED,
 - TEMPORARY SWALES,
 - SILT FENCE WHERE INDICATED,
 - TREE PRESERVATION, INSPECTION IS REQUIRED
 - TEMPORARY POND, IF REQUIRED,
 - SILT TRAPS.
- ACCUMULATED SILT TO BE REMOVED OFF SITE PRIOR TO REMOVAL OF ESC MEASURES.
- THE SILT FENCE MUST BE INSPECTED BI-WEEKLY AND IMMEDIATELY AFTER RAINFALL EVENTS FOR RIPS OR TEARS, BROKEN STAKES, BLOW OUTS (STRUCTURAL FAILURE) AND ACCUMULATION OF SEDIMENT. THE SILT FENCE MUST BE FIXED AND/OR REPLACED IMMEDIATELY WHEN DAMAGED. SEDIMENT MUST BE REMOVED FROM SILT FENCE WHEN ACCUMULATION REACHES 50% OF THE HEIGHT OF THE FENCE.
- THE OWNER WILL SEED, MULCH AND MAINTAIN THE ENTIRE SITE IF A BUILDING PERMIT IS NOT ISSUED WITHIN 365 DAYS OF THE SEDIMENT AND EROSION CONTROL PERMIT BEING USED.
- UPON COMPLETION OF LANDSCAPING ALL SEDIMENT AND EROSION CONTROL MEASURES SHALL BE REMOVED.
- NO CONSTRUCTION ACTIVITY OR MACHINERY SHALL BE BEYOND THE SILT FENCE.
- ALL TOPSOIL STOCKPILES SHALL BE SURROUNDED WITH A SEDIMENT CONTROL FENCE.
- ANY AREAS THAT ARE INACTIVE FOR MORE THAN 30 DAYS SHALL BE SEEDD AND/OR STABILIZED.

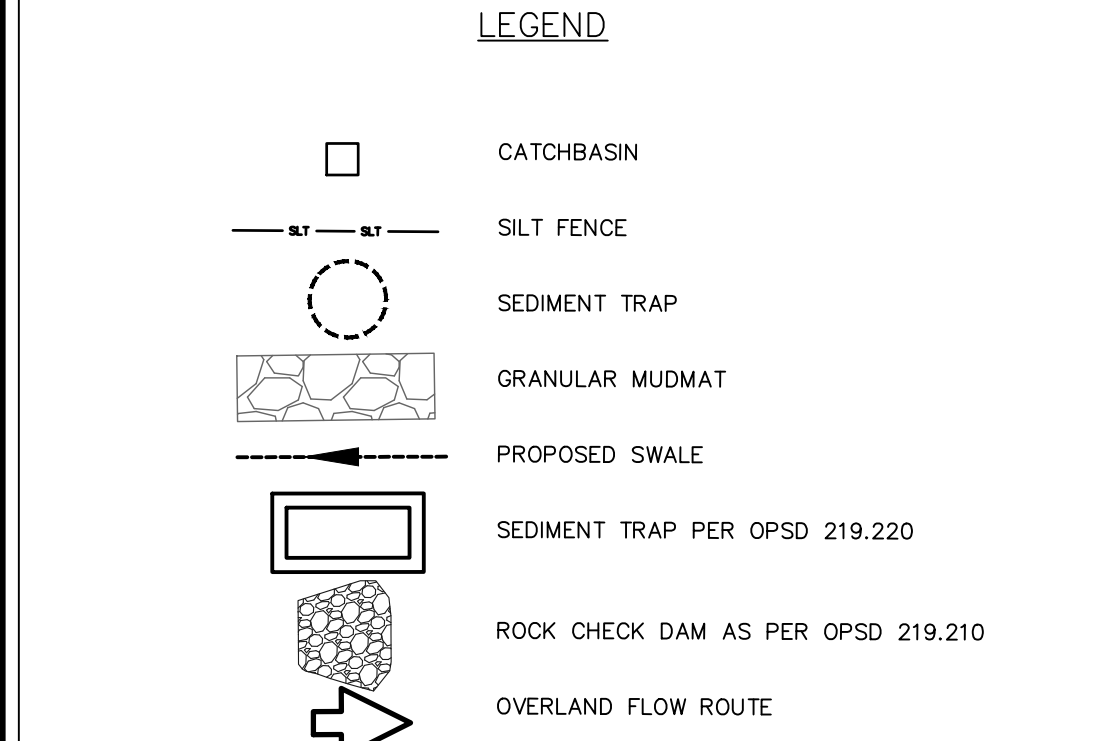
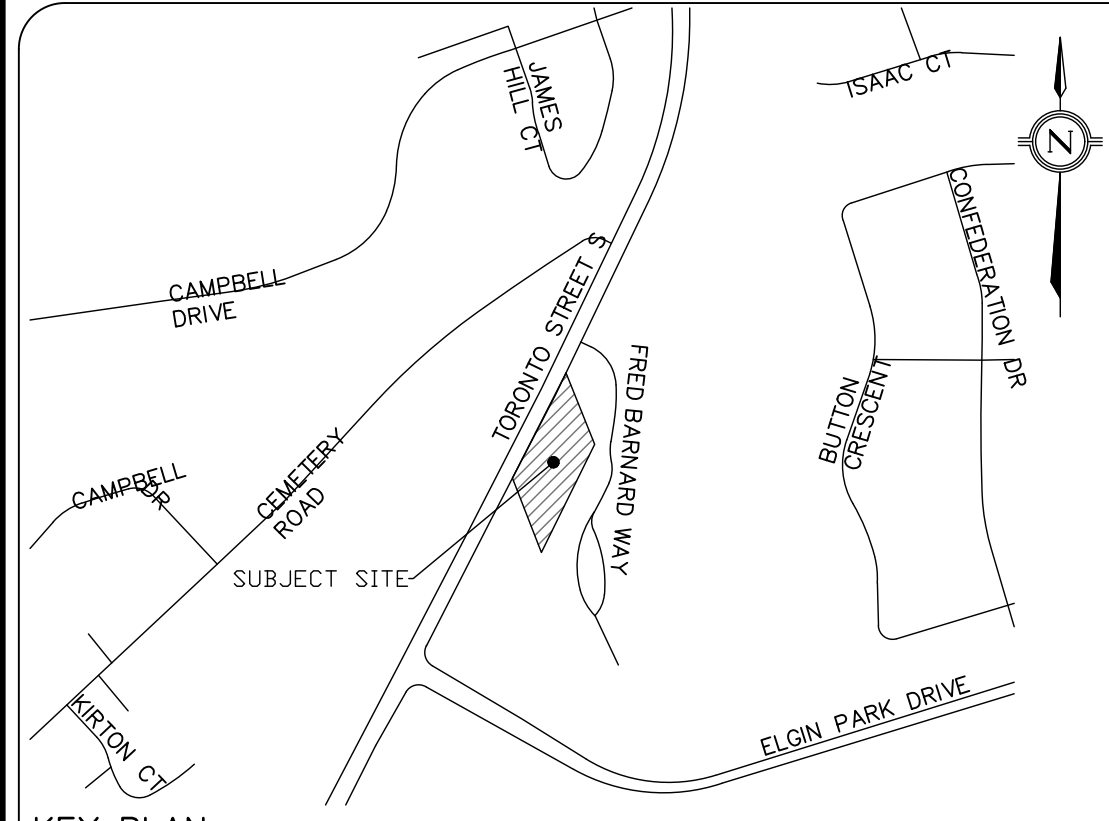
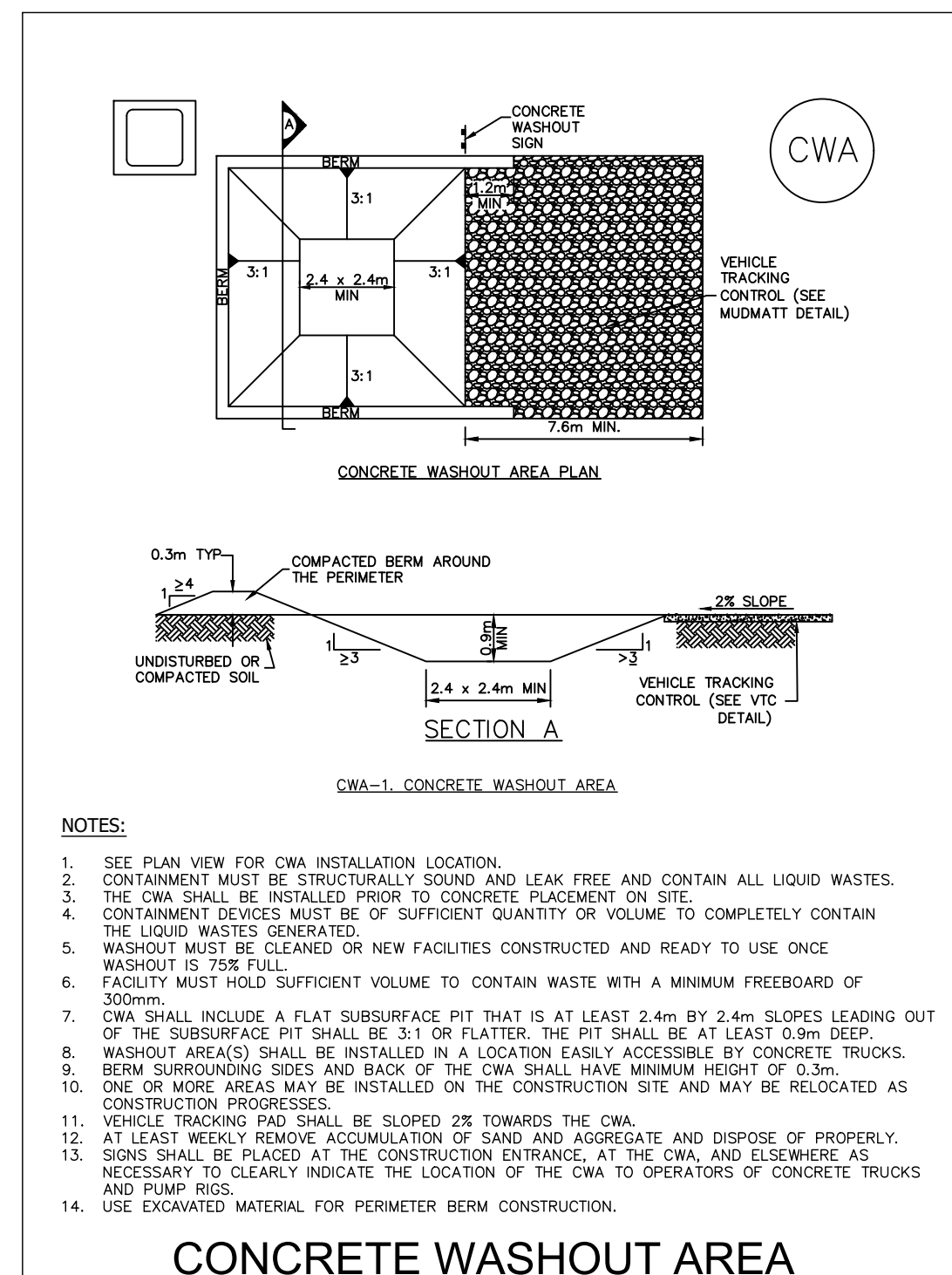
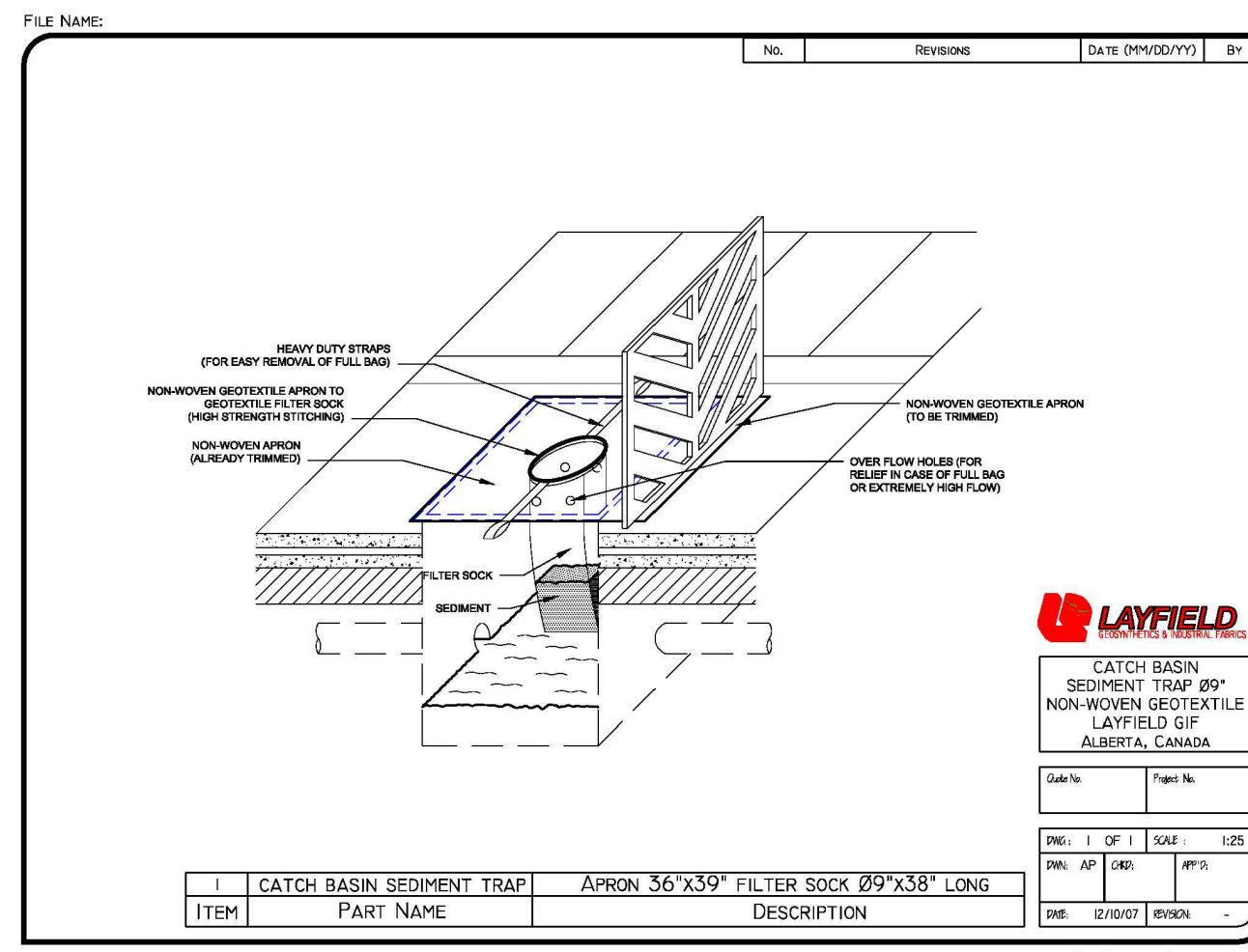
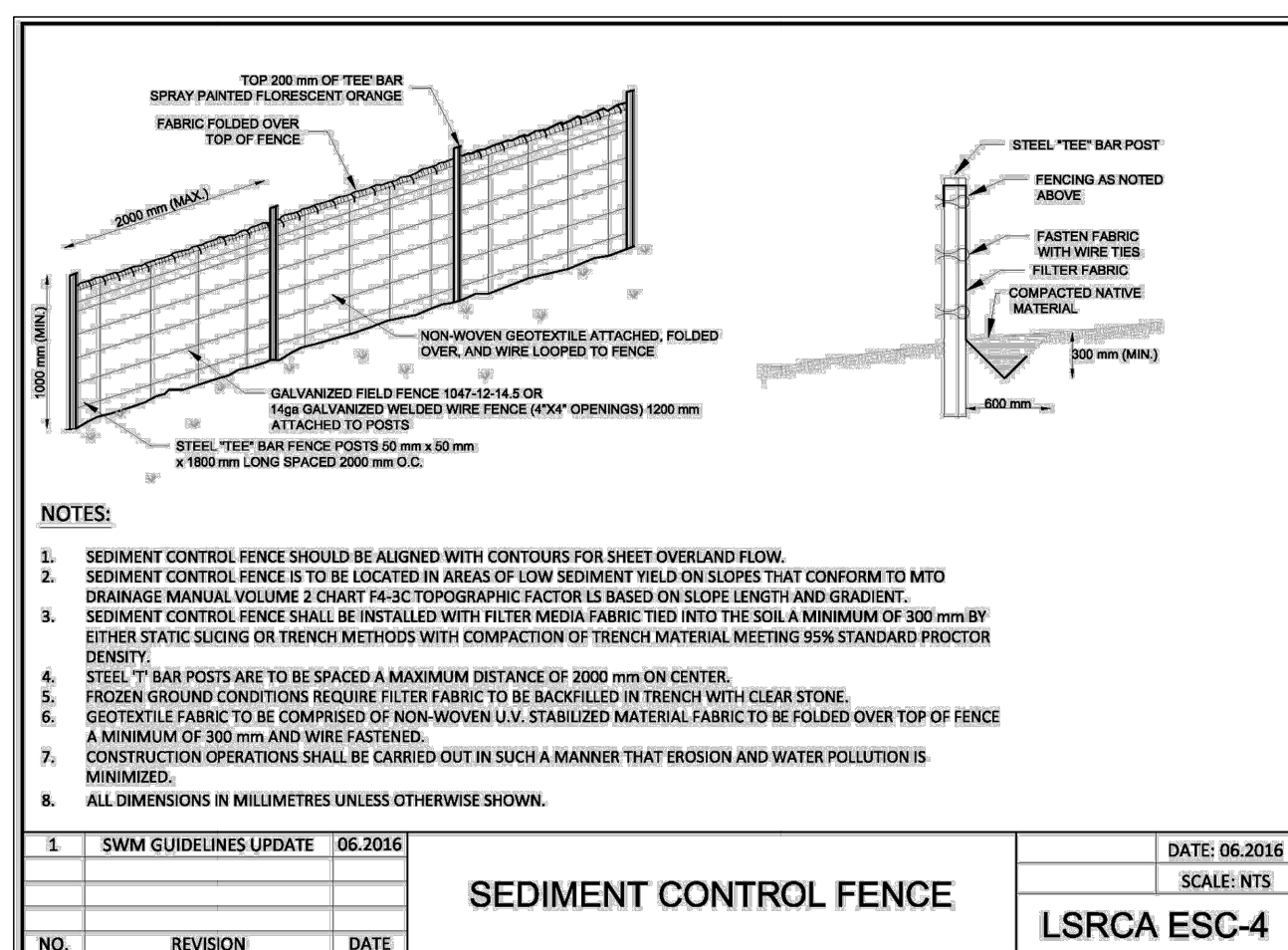
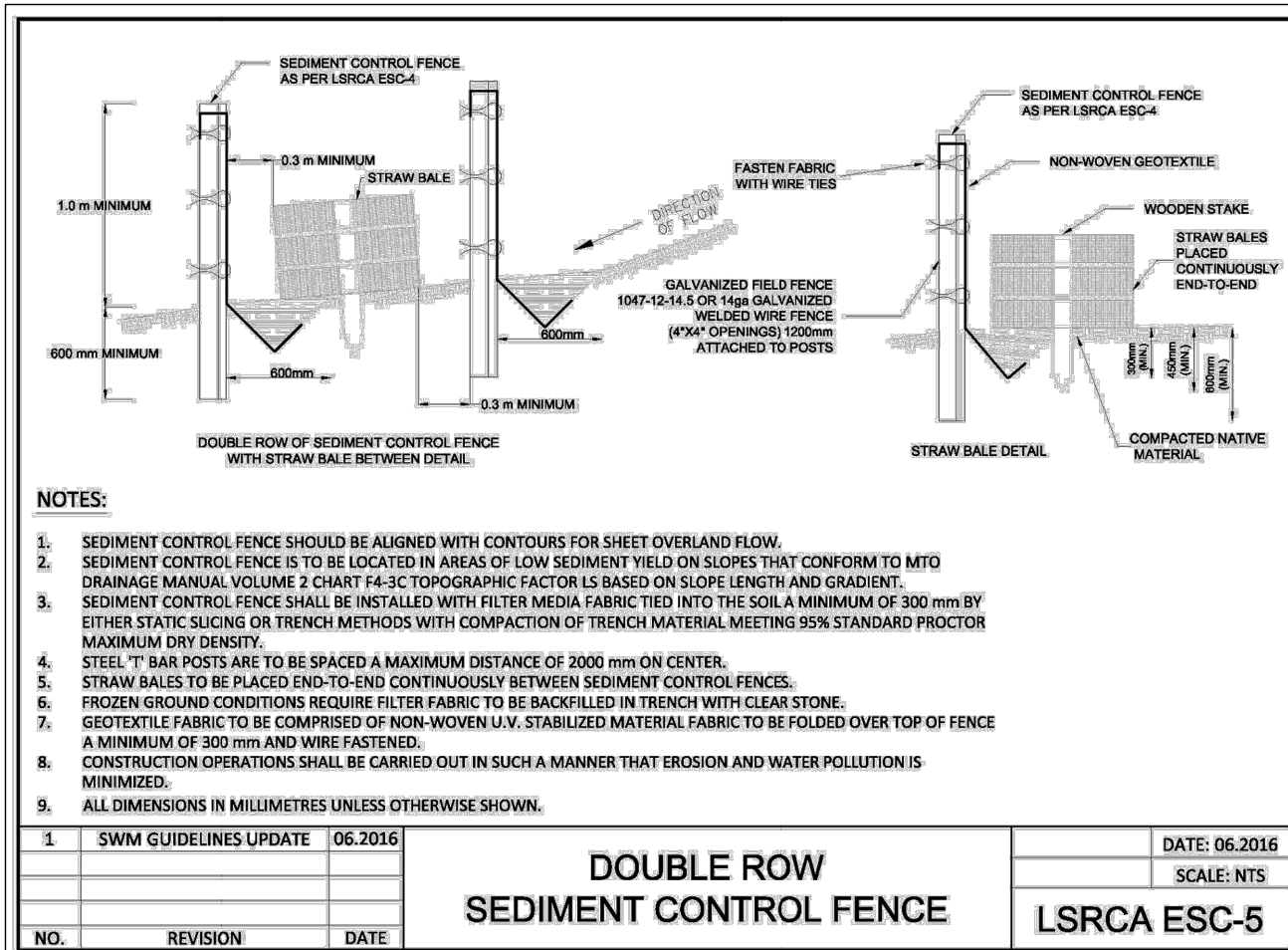
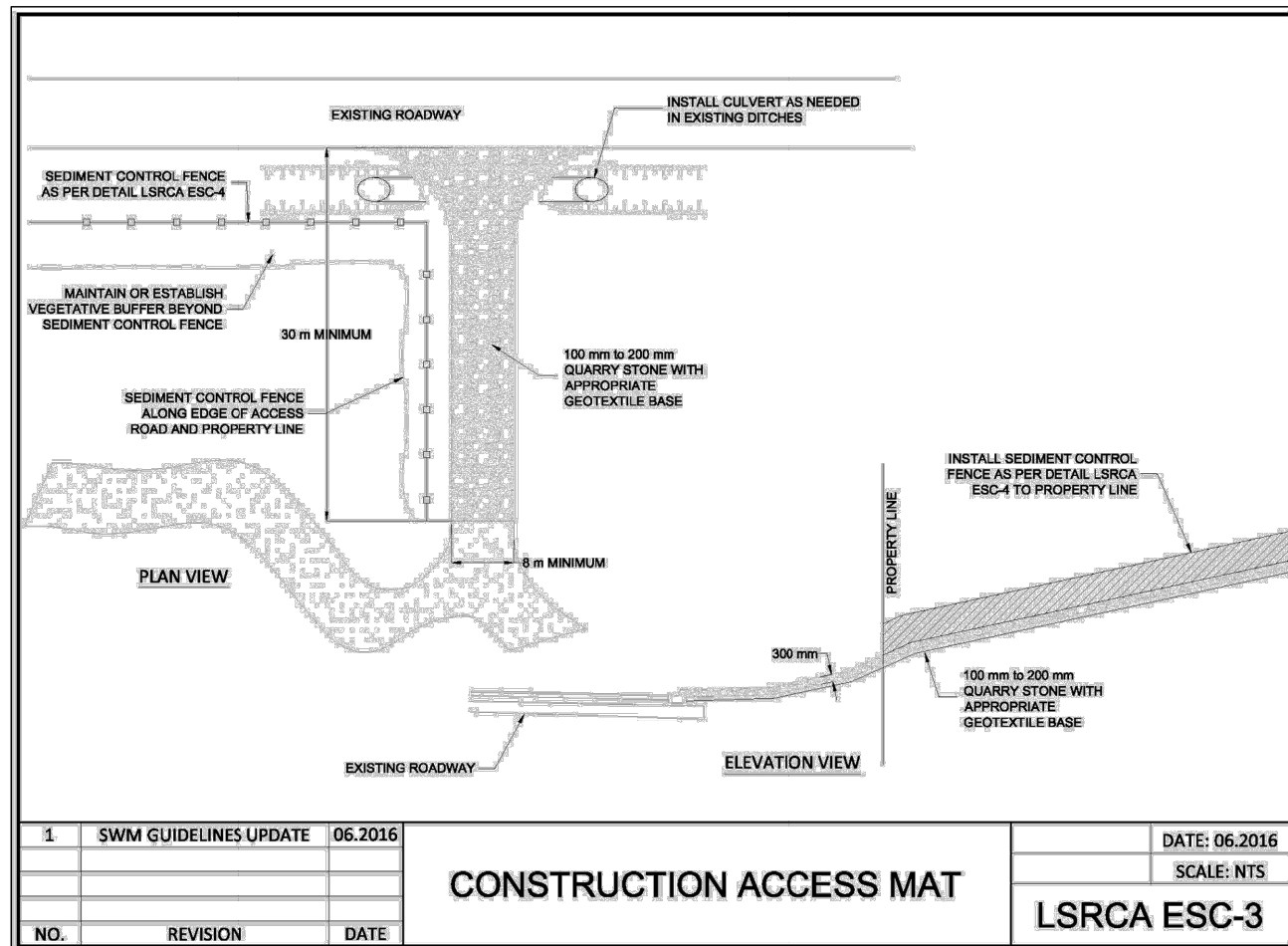
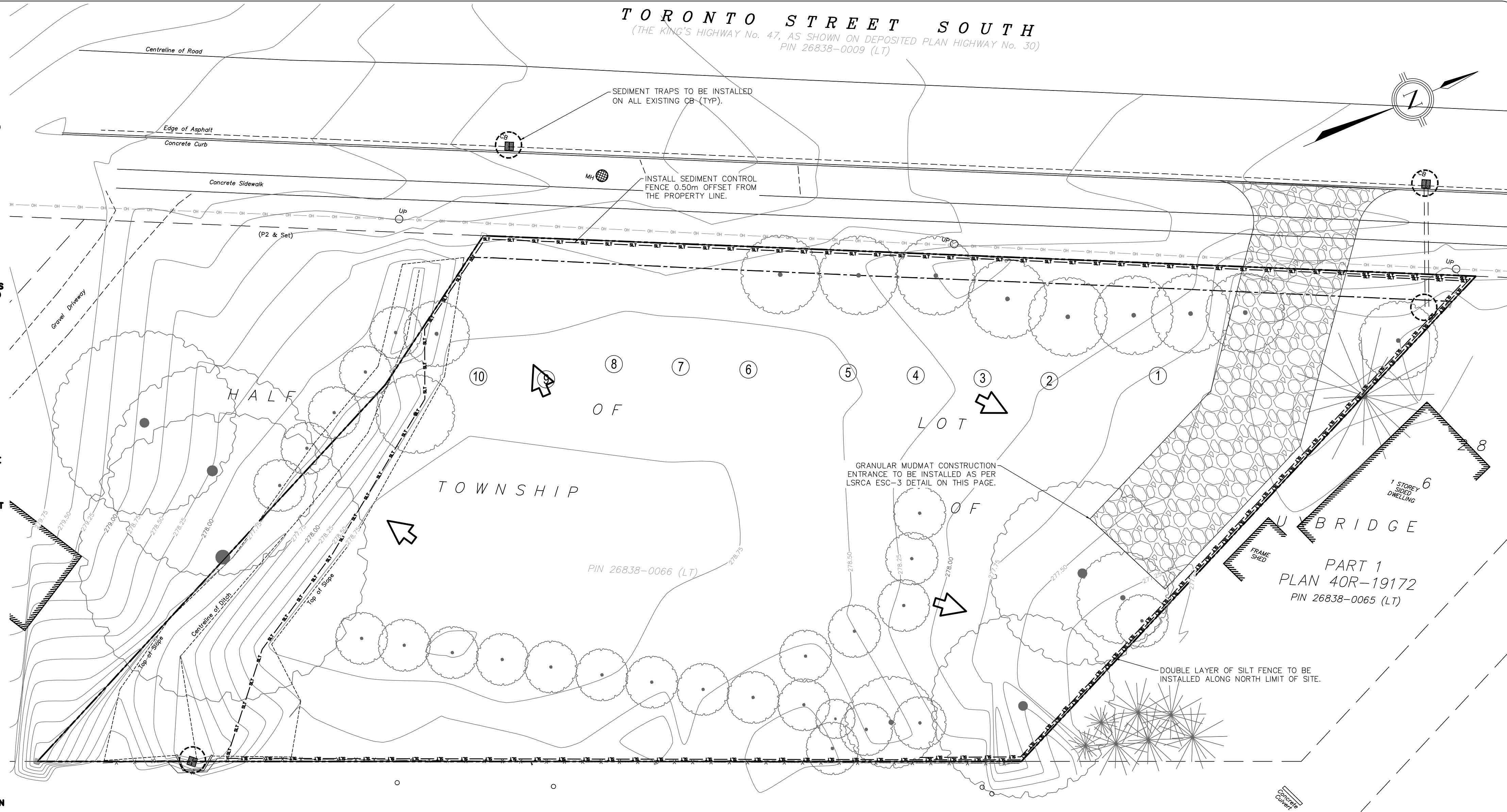

LEGAL & TOPOGRAPHY
 PROVIDED BY: BARICH GRENKIE
 257 HWY No. 8 (UNIT 101)
 STONEY CREEK, ON, L8G 1E5
 PHONE: (905) 662-6767

BENCHMARK AND ELEVATION
 ELEVATIONS SHOWN ARE REFERRED TO THE CANADIAN GEODETIC VERTICAL DATUM (CGVD-1928: 1978) AND ARE DERIVED FROM THE TOWNSHIP OF UXBRIDGE BENCHMARK No. 001193105175, HAVING AN ELEVATION OF 272.439 METERS.
 BEARINGS ARE UTM GRID, DERIVED FROM OBSERVED REFERENCE BY REAL TIME NETWORK (RTN) OBSERVATIONS, UTM ZONE 17 (81°00' WEST LONGITUDE) NAD83 (CSRS) (2010.0).
 ORP 1 - NORTHING (4884511.823), EASTING (649875.665).

1.	ISSUED FOR 1ST SUBMISSION	2022/05/16	P.T
No.	REVISIONS/ISSUED	DATE	BY CITY

counterpoint ENGINEERING
 COUNTERPOINT ENGINEERING INC.
 8395 Jane St., Suite 100, Vaughan, ON L4K 5Y2 Phone 905.326.1404 Fax 905.326.1405

ENGINEER'S STAMP
 P.A. TUNNEY
 10078657
 21/05/16
 PROVINCE OF ONTARIO

APPLICANT:
MANSOUR ARAB/MAN HOLDINGS LTD
 174 DINNIQ CRESCENT
 TORONTO, ONTARIO
 M4N 1M3

SITE LOCATION:
181 TORONTO STREET SOUTH
UXBRIDGE, ONTARIO

SITE PLAN FILE No.:

EROSION AND SEDIMENT CONTROL PLAN

DESIGNED BY:	CHECKED BY:	DATE: APRIL 2021
DRAWING BY:	CHECKED BY:	PROJECT NO. 21026
SWM BY:	CHECKED BY:	DRAWING NO. C-2

REGION FILE No.: