



ISSUED FOR SITE PLAN APPROVAL
2024-11-28

EARLY WORKS

DRAWING LIST

CIVIL DRAWINGS

C-01A	SITE GRADING PLAN (EARLY WORKS)
C-02A	SITE SERVICING PLAN (EARLY WORKS)
C-03A	EROSION AND SEDIMENT CONTROL PLAN (EARLY WORKS)
C-04A	GENERAL NOTES (EARLY WORKS)
C-05A	STANDARD DRAWINGS AND DETAILS (EARLY WORKS)

LANDSCAPE DRAWINGS

L000	EARLY WORKS - TREE PRESERVATION PLAN
L010	EARLY WORKS - LANDSCAPE DEMOLITION PLAN
L011	EARLY WORKS - LANDSCAPE DEMOLITION PLAN
L101	EARLY WORKS - LANDSCAPE SITE PLAN
L110	EARLY WORKS - LANDSCAPE SITE PLAN

ARCHITECTURAL DRAWINGS

EW002	SITE SURVEY
EW010	EARLY WORKS - CONTEXT PLAN
EW011A	EARLY WORKS - DEMOLITION SITE PLAN
EW011B	EARLY WORKS - DEMOLITION ENLARGED SITE PLAN
EW012A	EARLY WORKS - SITE PLAN
EW012B	EARLY WORKS - ENLARGED SITE PLAN
EW013	EARLY WORKS - PHASING DIAGRAMS
EW015	EARLY WORKS - EXISTING HOSPITAL

STRUCTURAL DRAWINGS

S100	EARLY WORKS GENERAL NOTES
S101	EARLY WORKS GENERAL NOTES
S200	EARLY WORKS - SITE PLAN

MECHANICAL DRAWINGS

M001E	MECHANICAL SYMBOLS, LEGENDS, DRAWING LIST & SITE PLAN - EARLY WORKS
M101E	FUEL TANK RELOCATION
M102E	AIR HANDLING UNIT RELOCATION
M103E	MECHANICAL DETAILS

ELECTRICAL DRAWINGS

E101E	ELECTRICAL SITE PLAN - EARLY WORKS
E201E	ELECTRICAL DETAILS & SINGLE LINE DIAGRAM - EARLY WORKS

Architect
Diamond Schmitt Architects
384 Adelaide Street West, Suite 100
Toronto, ON M5V 1R7
T: (416)-862-8800

Structural Consultant
Read Jones Christoffersen Ltd.
100 University Ave
Toronto, ON M5H 4H2
T: (416)-977-5335

Electrical Consultant
EXP
220 Commerce Valley Drive West, Suite 110
Markham, ON M3T 0A8
T: (905)-695-3217

Civil Consultant
LEA Consulting Ltd.
625 Cochrane Drive, 5th Floor
Markham, ON L3R 9R9
T: (905)-470-0015

Mechanical Consultant
EXP
220 Commerce Valley Drive West, Suite 110
Markham, ON M3T 0A8
T: (905)-695-3217

Landscape Architect
GSP Group
72 Victoria Street South, Suite 201
Kitchener, ON N2G 4Y9
T: (519)-569-8885

Issued		
No.	Date	Description
1	2024-07-11	OWNER REVIEW
2	2024-09-19	ISSUED FOR SITE PLAN APPROVAL
3	2024-11-28	ISSUED FOR SITE PLAN APPROVAL

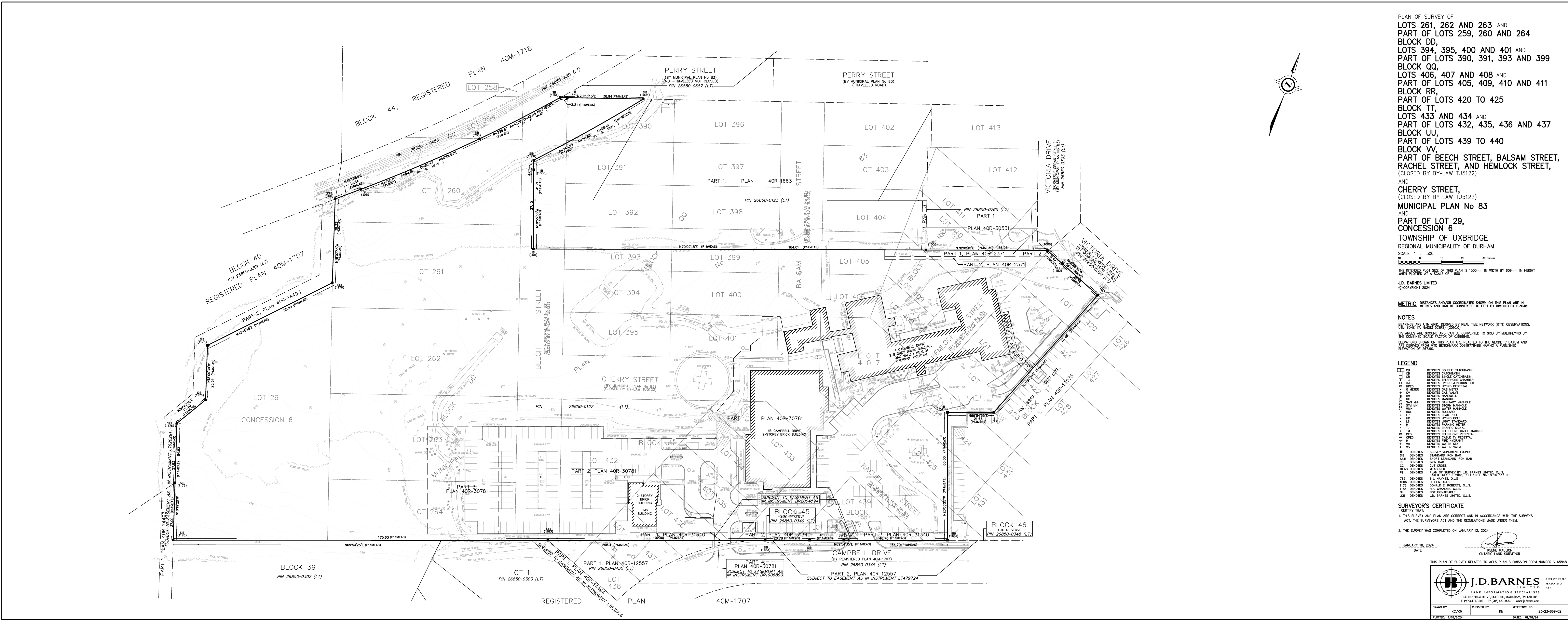

NOT FOR
CONSTRUCTION

Contractor Must Check & Verify all Dimensions on the Job.
Do Not Scale Drawings.
All Drawings, Specifications and Related Documents are the Copyright Property of
the Architect and Must be Returned Upon Request. Reproduction of Drawings,
Specifications and Related Documents in Part or in Whole is Forbidden Without the
Written permission of the Architect.
This Drawing is Not to be Used for Construction Until Signed by the Architect.

 **Uxbridge
Hospital**
Oak Valley Health

OAK VALLEY HEALTH -
UXBRIDGE HOSPITAL
4 CAMPBELL DRIVE, UXBRIDGE, ON
PROJECT NO.: 231022

Issued		
No.	Date	Description
1	2024-07-11	OWNER REVIEW
2	2024-09-19	ISSUED FOR SITE PLAN APPROVAL
3	2024-11-28	ISSUED FOR SITE PLAN APPROVAL

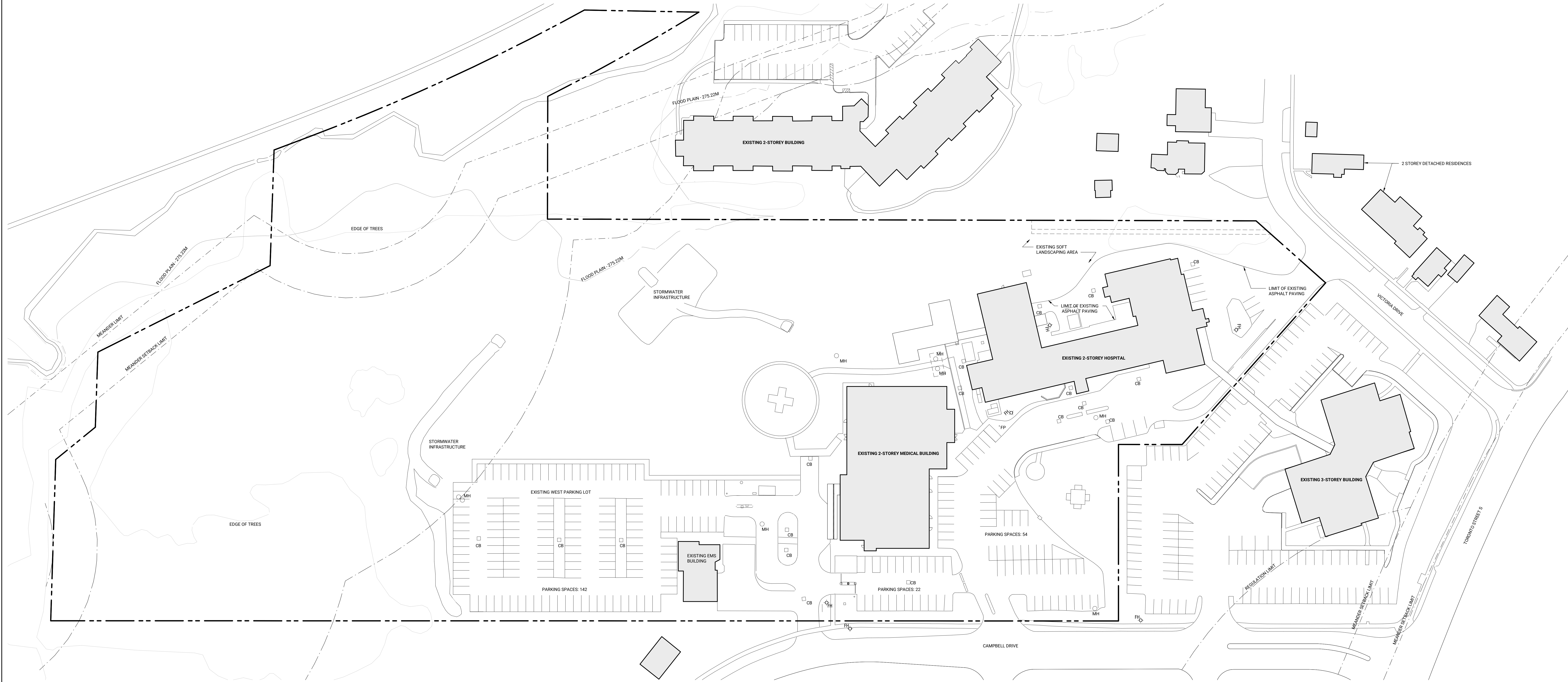

NOT FOR
CONSTRUCTION

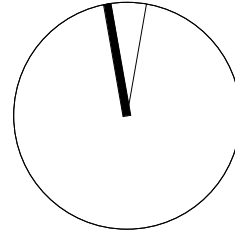

Contractor Must Check & Verify all Dimensions on the Job.
Do Not Scale Drawings.
All Drawings, Specifications and Related Documents are the Copyright Property of the Architect and Must be Returned Upon Request. Reproduction of Drawings, Specifications and Related Documents in Part or in Whole is Forbidden Without the Written permission of the Architect.
This Drawing is Not to be Used for Construction Until Signed by the Architect.



OAK VALLEY HEALTH -
UXBRIDGE HOSPITAL
4 CAMPBELL DRIVE, UXBRIDGE, ON
PROJECT NO.: 231022

EARLY WORKS - CONTEXT PLAN

1 : 500

EW010

DEMOLITION NOTES

1. SITE TO BE REGRADED FOR ACCESS ROAD AND LOADING DOCK. REFER TO CIVIL DRAWINGS.
2. EXISTING HVAC UNIT TO BE RELOCATED. CONCRETE PAD TO BE DEMOLISHED. REFER TO MECHANICAL DRAWINGS.
3. EXISTING MAINTENANCE BUILDING CONNECTION TO EXISTING HOSPITAL AND ALL RELATED INFRASTRUCTURE TO BE DEMOLISHED.
4. EXISTING HAMP TO BE DEMOLISHED.
5. EXISTING UNDERGROUND FUEL TANK TO BE DEMOLISHED.
6. CONCRETE PAD TO BE PARTIALLY DEMOLISHED.
7. FENCE TO BE DEMOLISHED AND LARGE SHRUB TO BE REMOVED. REFER TO LANDSCAPE.
8. ASPHALT TO BE REMOVED FOR SITE SERVICES TO BE INSTALLED. REFER TO CIVIL.
9. SAWCUT EXISTING ASPHALT DRIVE FOR CONNECTION TO NEW PARKING AREA.
10. DEMOLISH EXISTING EMS AMBULANCE GARAGE. CUT AND CAP EXISTING SERVICES (REFER TO CIVIL DRAWINGS). SAWCUT EXISTING ASPHALT PAVING FOR CONNECTION TO NEW PARKING AREA.
11. EXISTING PARKING, SIGNAGE, SIDEWALKS ETC. TO BE DEMOLISHED.
12. HILLROAD TO BE DECOMMISSIONED. LIGHTS AND WINDSOCK TO BE REMOVED. HOSPITAL SYMBOL TO BE PAINTED OVER.
13. INFILTRATION INFRASTRUCTURE TO BE REMOVED.
14. DRAINAGE INFRASTRUCTURE TO BE REMOVED.
15. EXISTING TREES TO BE REMOVED. SEE LANDSCAPE.

Issued	No.	Date	Description
1	1	2024-11-28	ISSUED FOR SITE PLAN APPROVAL

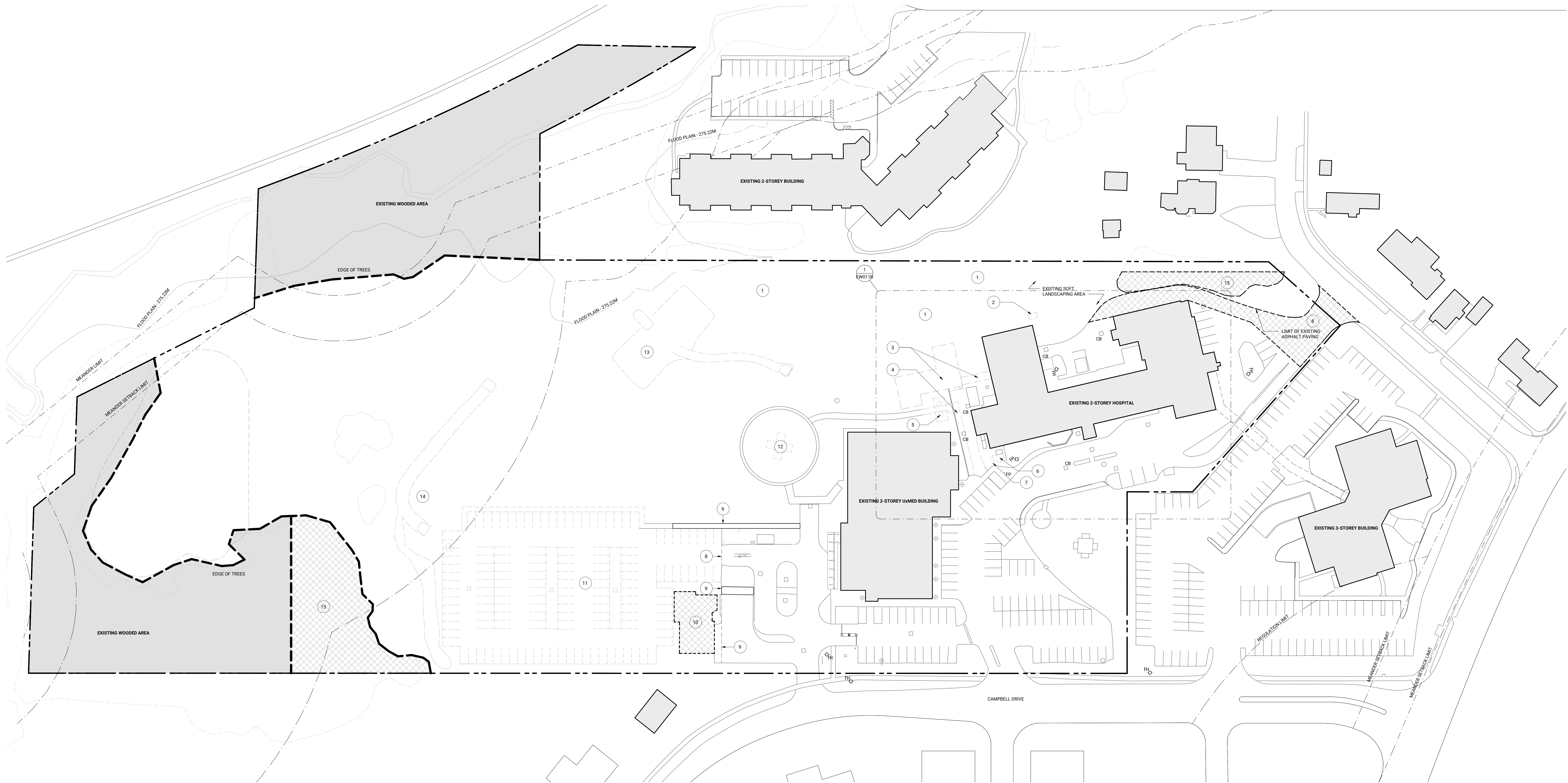

NOT FOR
CONSTRUCTION

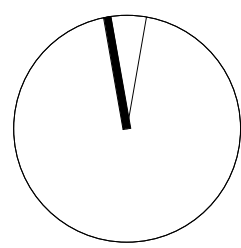

Contractor Must Check & Verify all Dimensions on the Job.
Do Not Scale Drawings.
All Drawings, Specifications and Related Documents are the Copyright Property of the Architect and Shall be Kept Under Strict Control. Reproduction or Drawing, Specifications and Related Documents in Part or in Whole is Forbidden Without the Written permission of the Architect.
This Drawing is Not to be Used for Construction Until Signed by the Architect.



OAK VALLEY HEALTH -
UXBRIDGE HOSPITAL
4 CAMPBELL DRIVE, UXBRIDGE, ON
PROJECT NO.: 231022

EARLY WORKS - DEMOLITION SITE
PLAN
1 : 500

EW011A

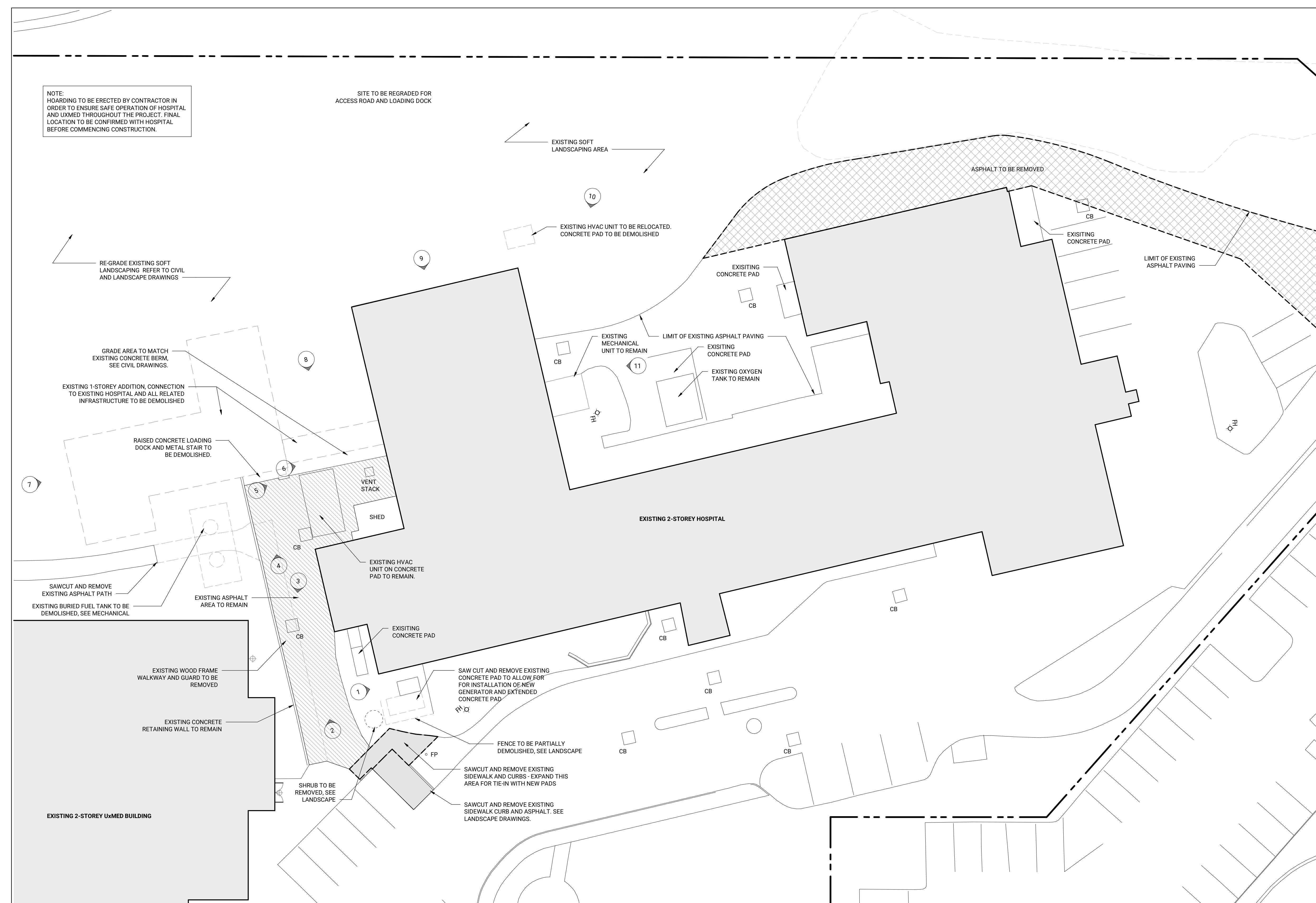
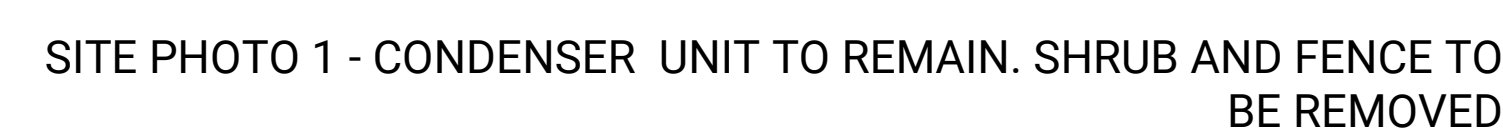
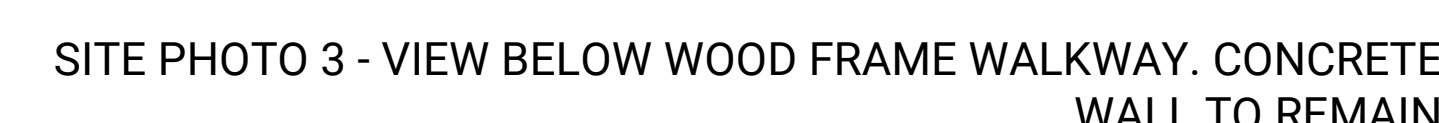
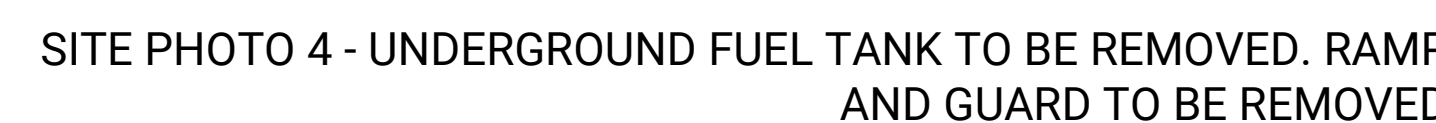
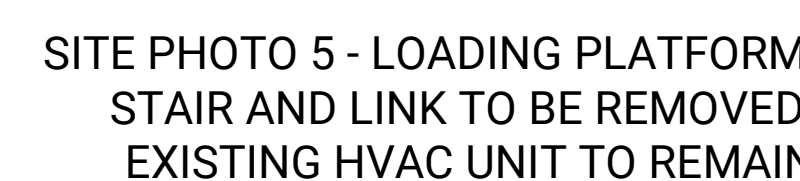
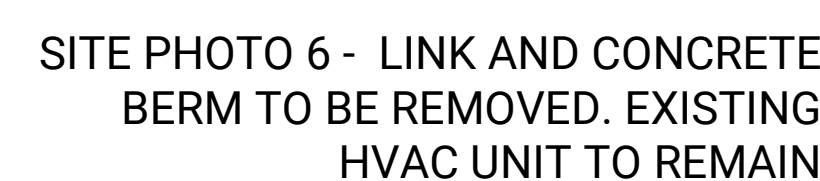

NOT FOR
CONSTRUCTION

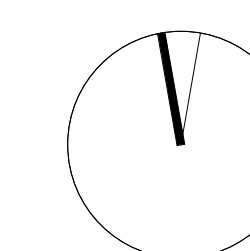

Contractor Must Check & Verify all Dimensions on the Job.
Do Not Scale Drawings.

All Drawings, Specifications and Related Documents are the Copyright Property of the Architect and Must be Returned Upon Request. Reproduction of Drawings, Specifications and Related Documents in Part or in Whole is Forbidden Without Written permission of the Architect.

This Drawing is Not to be Used for Construction Until Signed by the Architect.



OAK VALLEY HEALTH -
UXBRIDGE HOSPITAL
4 CAMPBELL DRIVE, UXBRIDGE, ON
PROJECT NO.: 231022

EARLY WORKS - DEMOLITION
ENLARGED SITE PLAN

12

EW011B

- SITE NOTES
1. CONCRETE RETAINING WALL, SEE STRUCTURAL.
 2. CONCRETE RETAINING WALL WITH BOLLARDS, SEE STRUCTURAL.
 3. ACCESS ROAD, SEE CIVIL.
 4. PRECAST BARRIER CURBS, SEE LANDSCAPE.
 5. ROUGH GRADES ARE FOR FUTURE LOADING PADDOCK, SEE CIVIL.
 6. CONCRETE PAD AND BOLLARDS FOR FUTURE ELECTRICAL SUBSTATION, SEE STRUCTURAL AND ELECTRICAL.
 7. DECOMMISSION HELIPAD, REMOVE LIGHTS, WINDSOCK AND HOSPITAL SYMBOL.
 8. ROUGH GRADE FUTURE PARKING AREA, SEE CIVIL.
 9. STORMWATER MANAGEMENT POND AND ACCESS ROAD, SEE CIVIL.
 10. NEW 1800mm HIGH CHAINLINK FENCE.

Issued	No.	Date	Description
1		2024-11-28	ISSUED FOR SITE PLAN APPROVAL

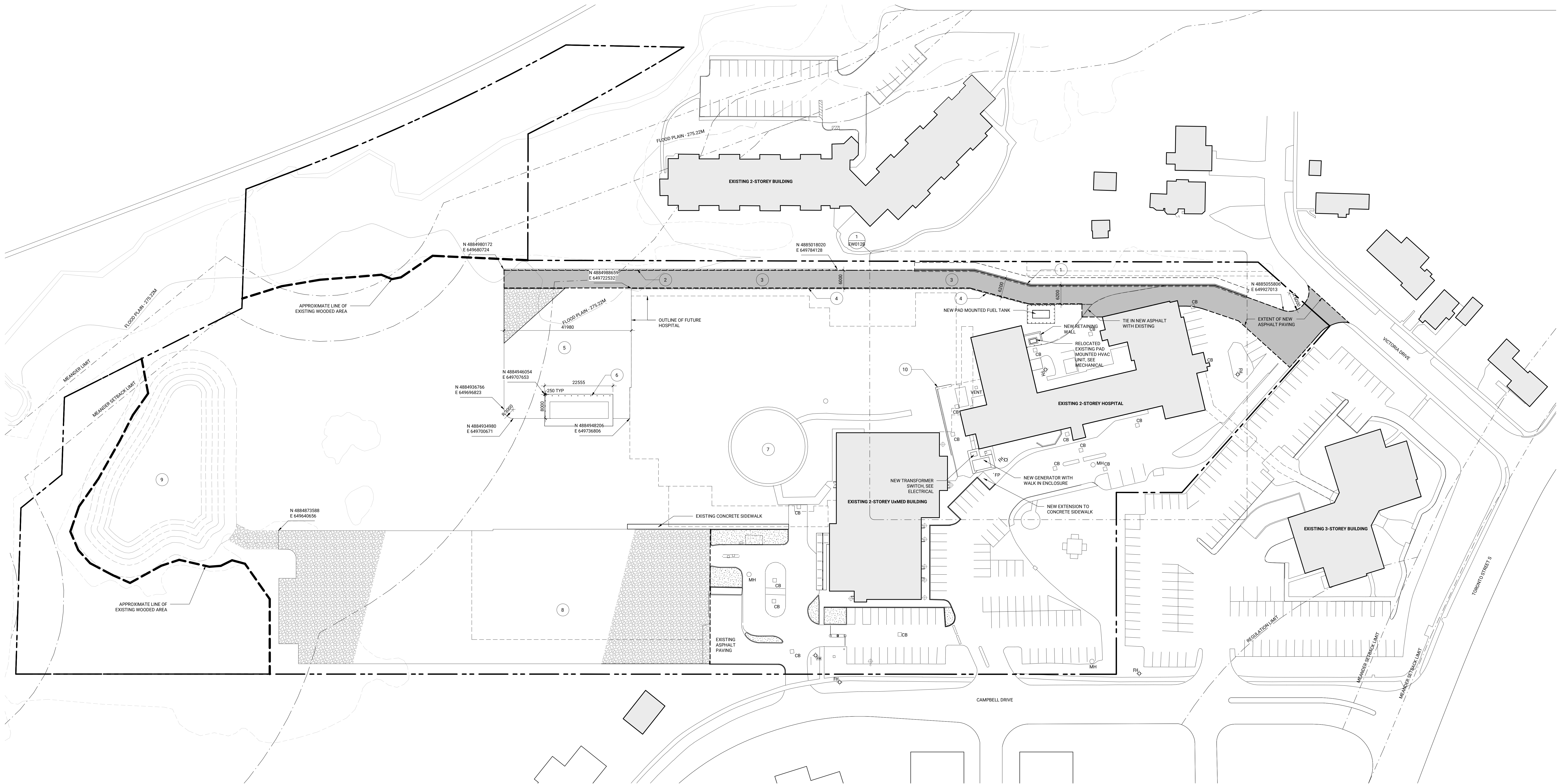

NOT FOR
CONSTRUCTION

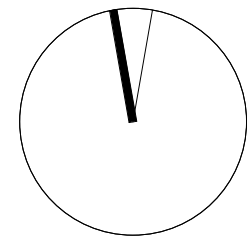

Contractor Must Check & Verify all Dimensions on the Job.
Do Not Scale Drawings.
All Drawings, Specifications and Related Documents are the Copyright Property of the Architect and Must be Returned Upon Request. Reproduction of Drawings, Specifications and Related Documents in Part or in Whole is Forbidden Without the Written permission of the Architect.
This Drawing is Not to be Used for Construction Until Signed by the Architect.



OAK VALLEY HEALTH -
UXBRIDGE HOSPITAL
4 CAMPBELL DRIVE, UXBRIDGE, ON
PROJECT NO.: 231022

EARLY WORKS - SITE PLAN
1 : 500

EW012A

Issued		
No.	Date	Description
1	2024-07-11	OWNER REVIEW
2	2024-09-19	ISSUED FOR SITE PLAN APPROVAL
3	2024-11-28	ISSUED FOR SITE PLAN APPROVAL

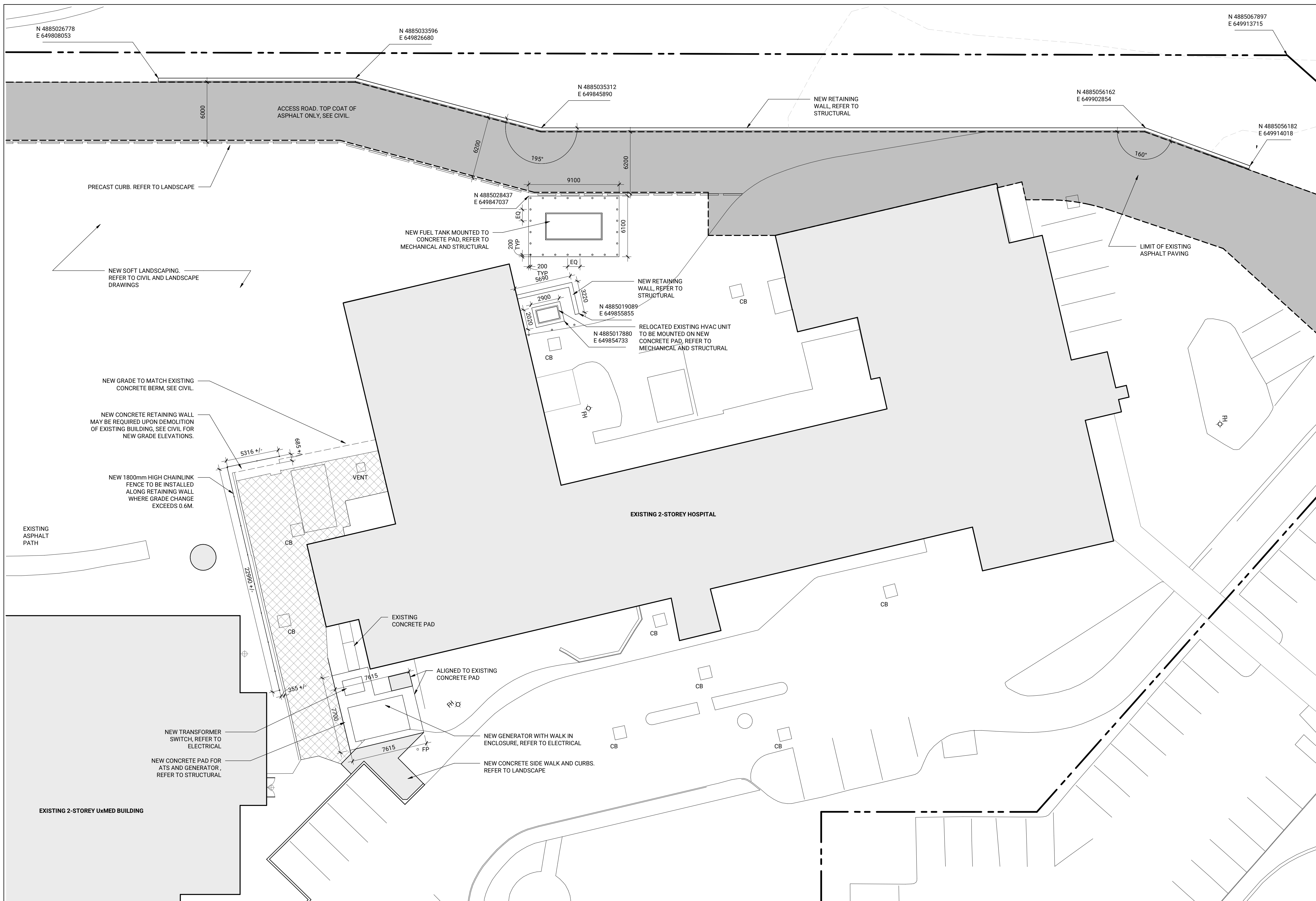

NOT FOR
CONSTRUCTION

Contractor Must Check & Verify all Dimensions on the Job.
Do Not Scale Drawings.
All Drawings, Specifications and Related Documents are the Copyright Property of
the Architect and Must be Returned Upon Request. Reproduction of Drawings,
Specifications and Related Documents in Part or in Whole is Forbidden Without the
Written permission of the Architect.
This Drawing is Not to be Used for Construction Until Signed by the Architect.



OAK VALLEY HEALTH -
UXBRIDGE HOSPITAL
4 CAMPBELL DRIVE, UXBRIDGE, ON
PROJECT NO.: 231022

EARLY WORKS - ENLARGED SITE
PLAN

1 : 200
EW012B

Issued		
No.	Date	Description
1	2024-07-11	OWNER REVIEW
2	2024-09-19	ISSUED FOR SITE PLAN APPROVAL
3	2024-11-28	ISSUED FOR SITE PLAN APPROVAL

11. DEMOLISHED EXISTING BUILDING AND LINK.
12. REMOVED EXISTING FUEL TANK, SEE MECHANICAL.
13. NEW RETAINING WALL AT NORTH WEST CORNER OF DEPRESSED AREA.
14. REGRADED SITE, SEE CIVIL.
15. REMOVED EXISTING RAMP.
16. NEW CHAIN LINK FENCE.

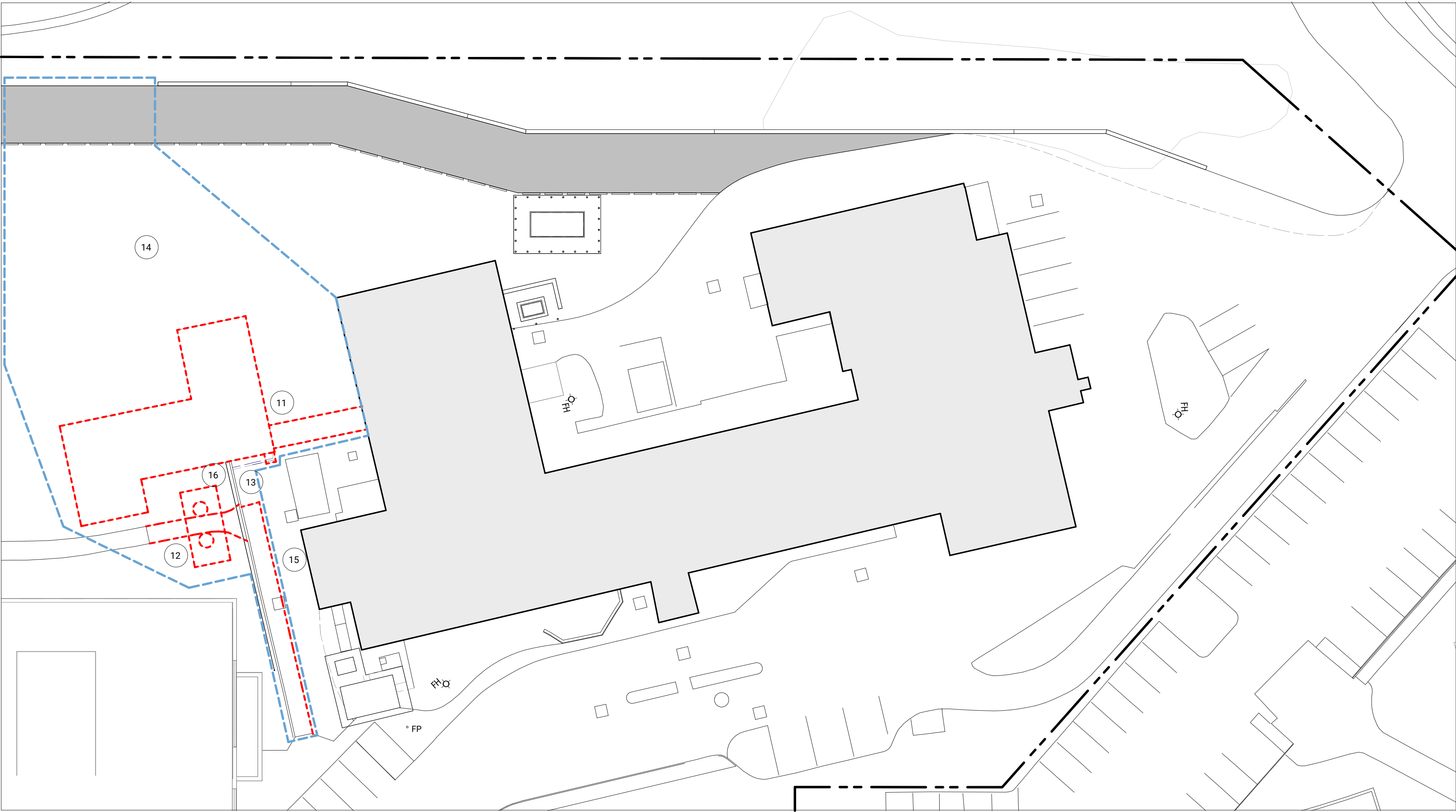

PHASE 3
1 : 300
EW013

FINAL PHASE
1 : 300
EW013

5. NEW CONCRETE PADS FOR ATS, GENERATOR AND SIDE WALK EXTENSION, SEE STRUCTURAL.
6. NEW ATS AND GENERATOR, SEE ELECTRICAL.
7. LEVEL GRADE ON EAST SIDE OF EARLY WORKS AREA, SEE CIVIL.
8. NEW NORTH RETAINING WALL, SEE STRUCTURAL, NEW SERVICE ROAD AND UNDERGROUND SERVICES, SEE CIVIL.
9. NEW OIL TANK, SEE MECHANICAL.

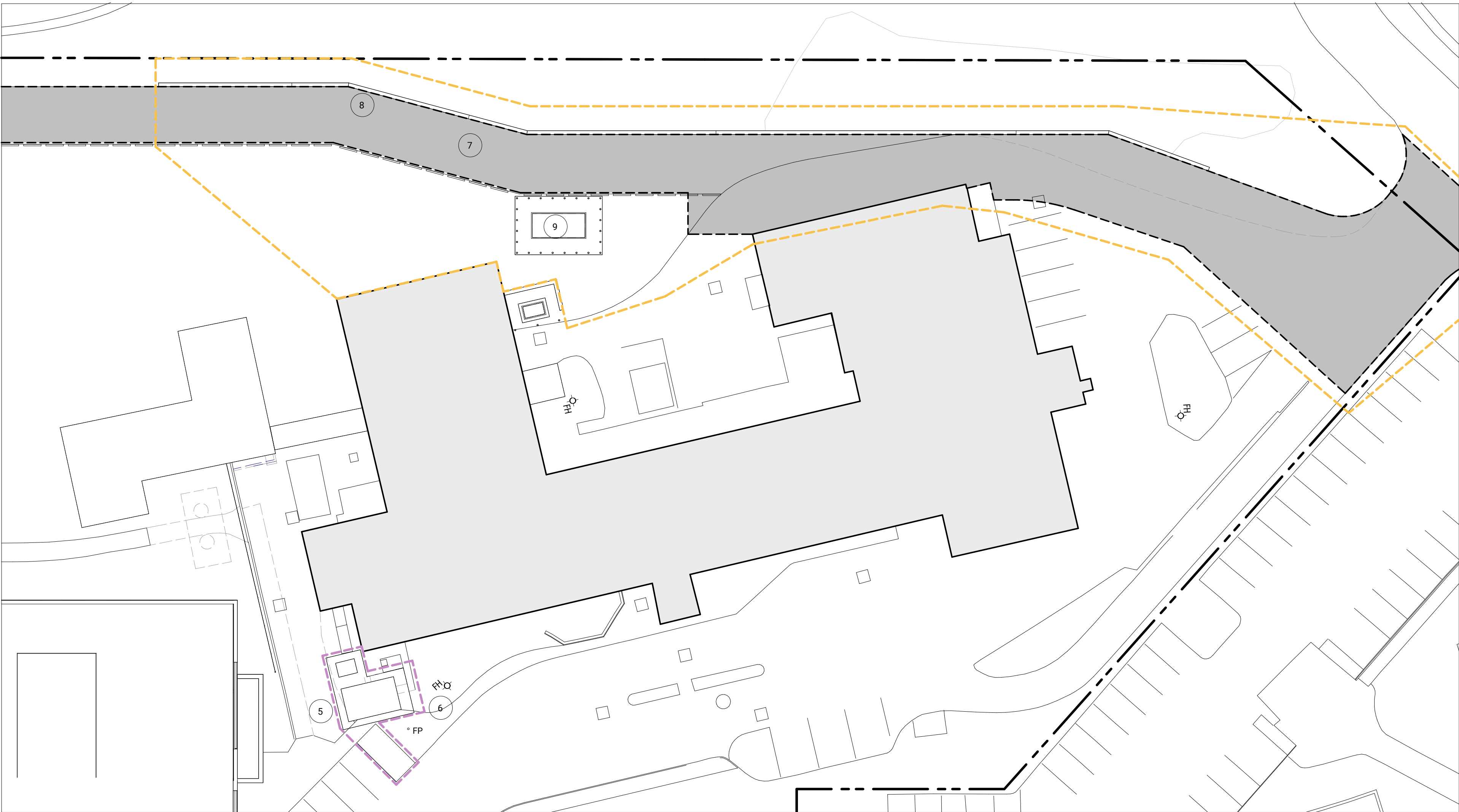

PHASE 2
1 : 300
EW013

1. REGRADED AREA FOR LOCATION FOR RELOCATED AHU UNIT, SEE CIVIL.
2. NEW RETAINING WALL AND CONCRETE PAD, SEE STRUCTURAL.
3. RELOCATED EXISTING AHU, SEE MECHANICAL.
4. REMOVED EXISTING FENCE, SHRUB AND SOFT LANDSCAPING, SEE LANDSCAPE.
5. EXISTING SOFT LANDSCAPING.

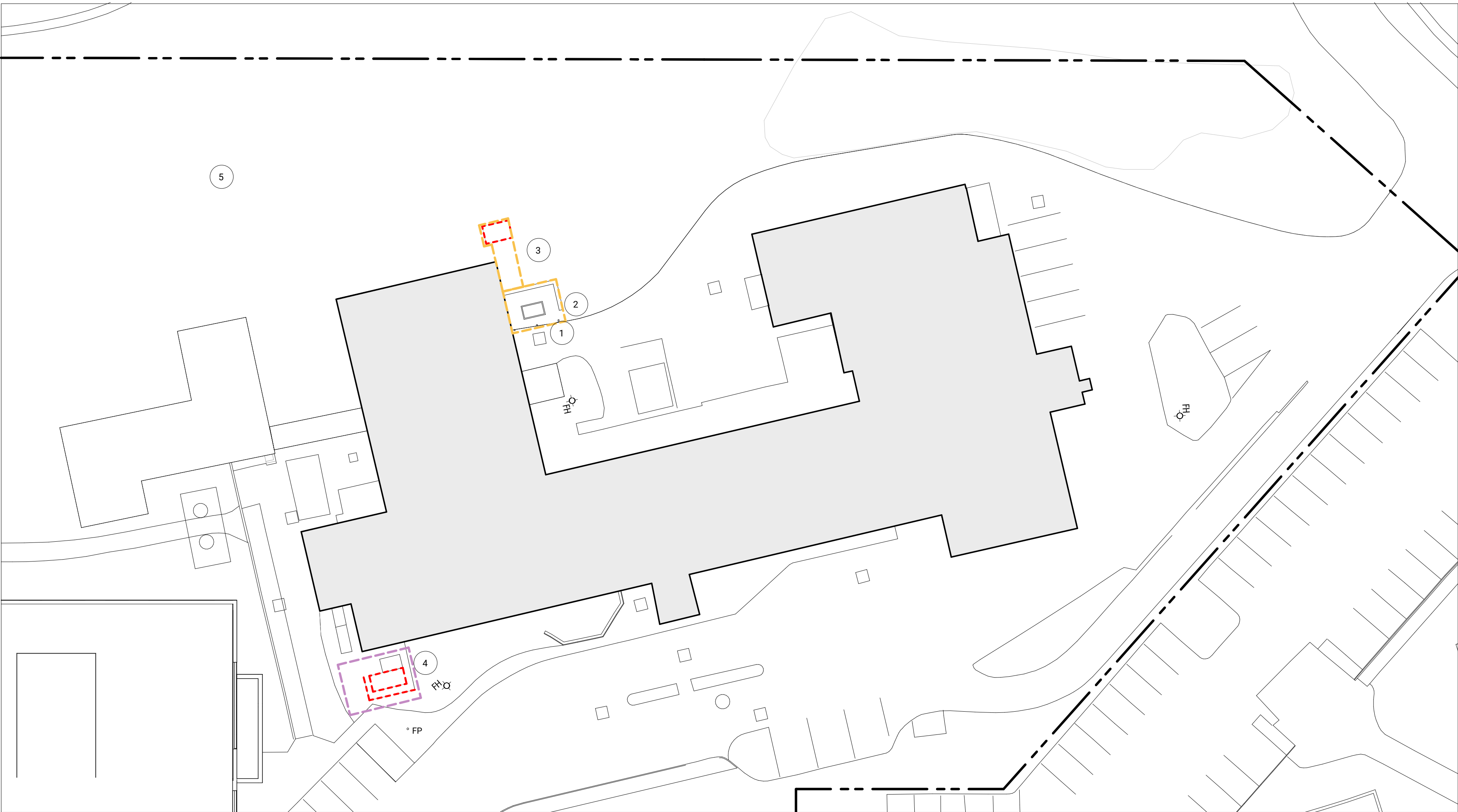

PHASE 1
1 : 300
EW013

NOT FOR
CONSTRUCTION

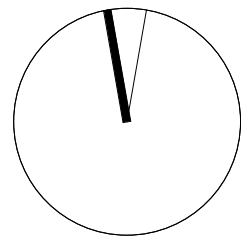

Contractor Must Check & Verify all Dimensions on the Job.
Do Not Scale Drawings.
All Drawings, Specifications and Related Documents are the Copyright Property of
the Architect and Must be Returned Upon Request. Reproduction of Drawings,
Specifications and Related Documents in Part or in Whole is Forbidden Without the
Written permission of the Architect.
This Drawing is Not to be Used for Construction Until Signed by the Architect.



OAK VALLEY HEALTH -
UXBRIDGE HOSPITAL
4 CAMPBELL DRIVE, UXBRIDGE, ON
PROJECT NO.: 231022

EARLY WORKS - PHASING
DIAGRAMS

1 : 300
EW013

Issued		
No.	Date	Description
1	2024-07-11	OWNER REVIEW
2	2024-09-19	ISSUED FOR SITE PLAN APPROVAL
3	2024-11-28	ISSUED FOR SITE PLAN APPROVAL

INTERIOR PARTITION TYPES				
P43	STC 47 OBC SB-3 S4b	-		P43 PARTITION WITH INSULATION 16mm GYPSUM BOARD 92mm METAL STUDS at 400mmOC 89mm ACOUSTIC INSULATION 16mm GYPSUM BOARD

PARTITION TYPE

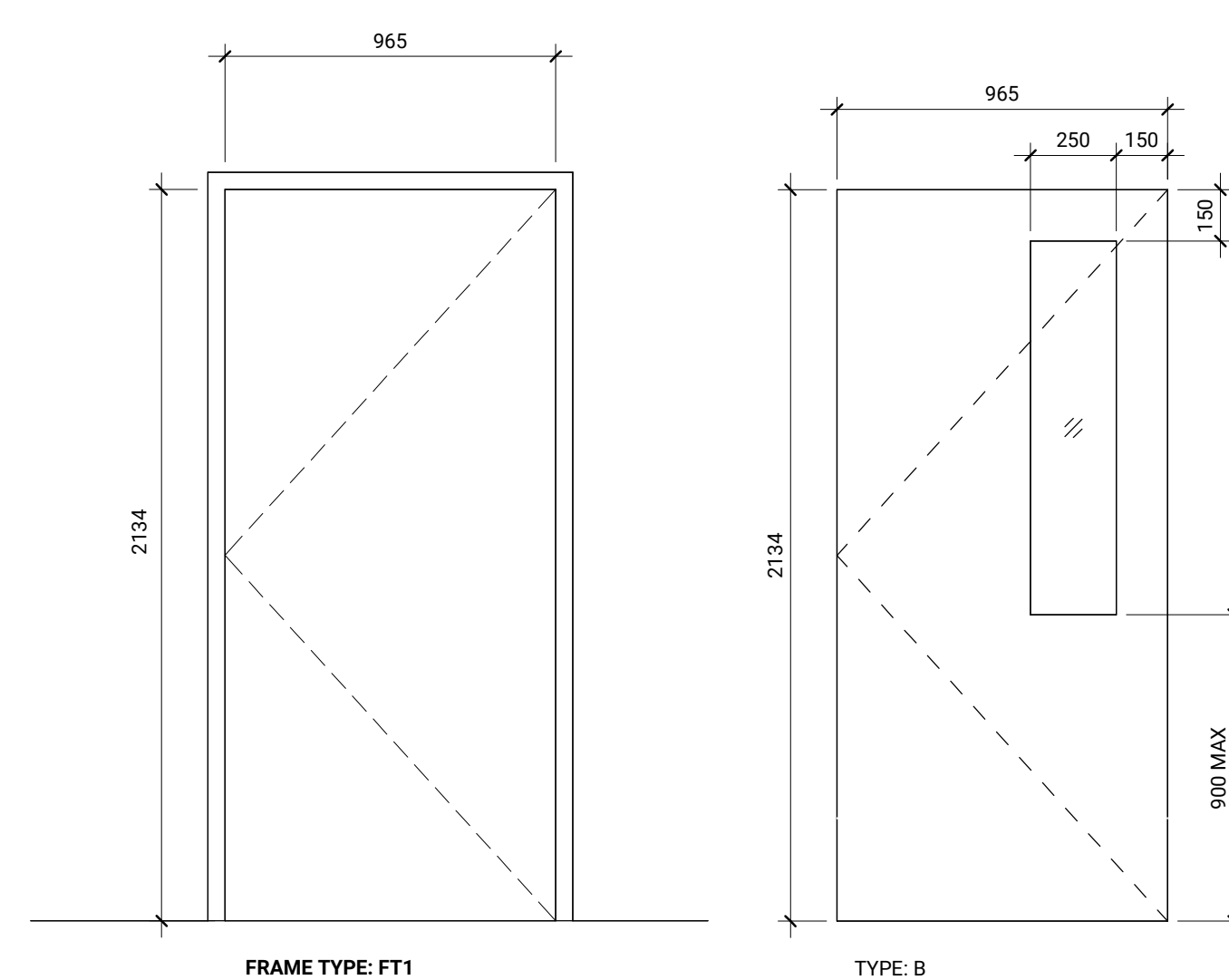

DOOR AND FRAME TYPE

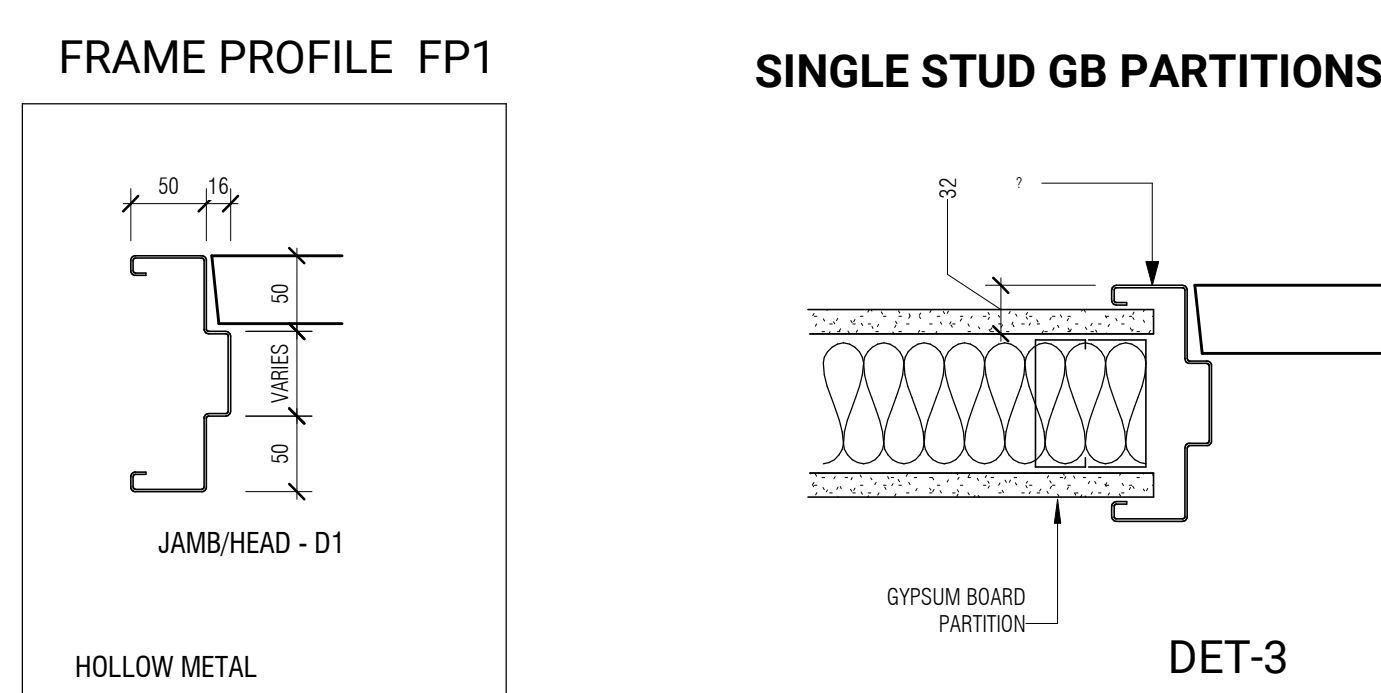

FRAME PROFILE AND DETAIL



NOT FOR
CONSTRUCTION

Contractor Must Check & Verify all Dimensions on the Job.
Do Not Scale Drawings.
All Drawings, Specifications and Related Documents are the Copyright Property of the Architect and Must be Returned Upon Request. Reproduction of Drawings, Specifications and Related Documents in Part or in Whole is Forbidden Without Written permission of the Architect.
This Drawing is Not to be Used for Construction Until Signed by the Architect.



OAK VALLEY HEALTH -
UXBRIDGE HOSPITAL
4 CAMPBELL DRIVE, UXBRIDGE, ON
PROJECT NO.: 231022

EARLY WORKS - EXISTING HOSPITAL
As indicated

EW015