

KEY MAP
SITE

LEGEND

- EXISTING TREES
- PROPOSED DECIDUOUS TREES
- PROPOSED CONIFEROUS TREES
- PLANTING BED
- SOD
- SEED MIX 'A'
- SEED MIX 'B'
- CONCRETE PAVING
- DECORATIVE CONCRETE PAVING
- GRAVEL PATH
- BENCH
- BIKE RACK
- SAFETY BOLLARD
- WASTE RECEPTACLE
- EXTENT OF BIOSWALE
- PROPERTY BOUNDARY
- RETAINING WALL (REFER TO STRUCTURAL AND CIVIL EARLY WORKS DRAWINGS)
- FENCING (REFER TO LANDSCAPE EARLY WORKS DRAWINGS)

NORTH WALL ENLARGEMENT PLAN

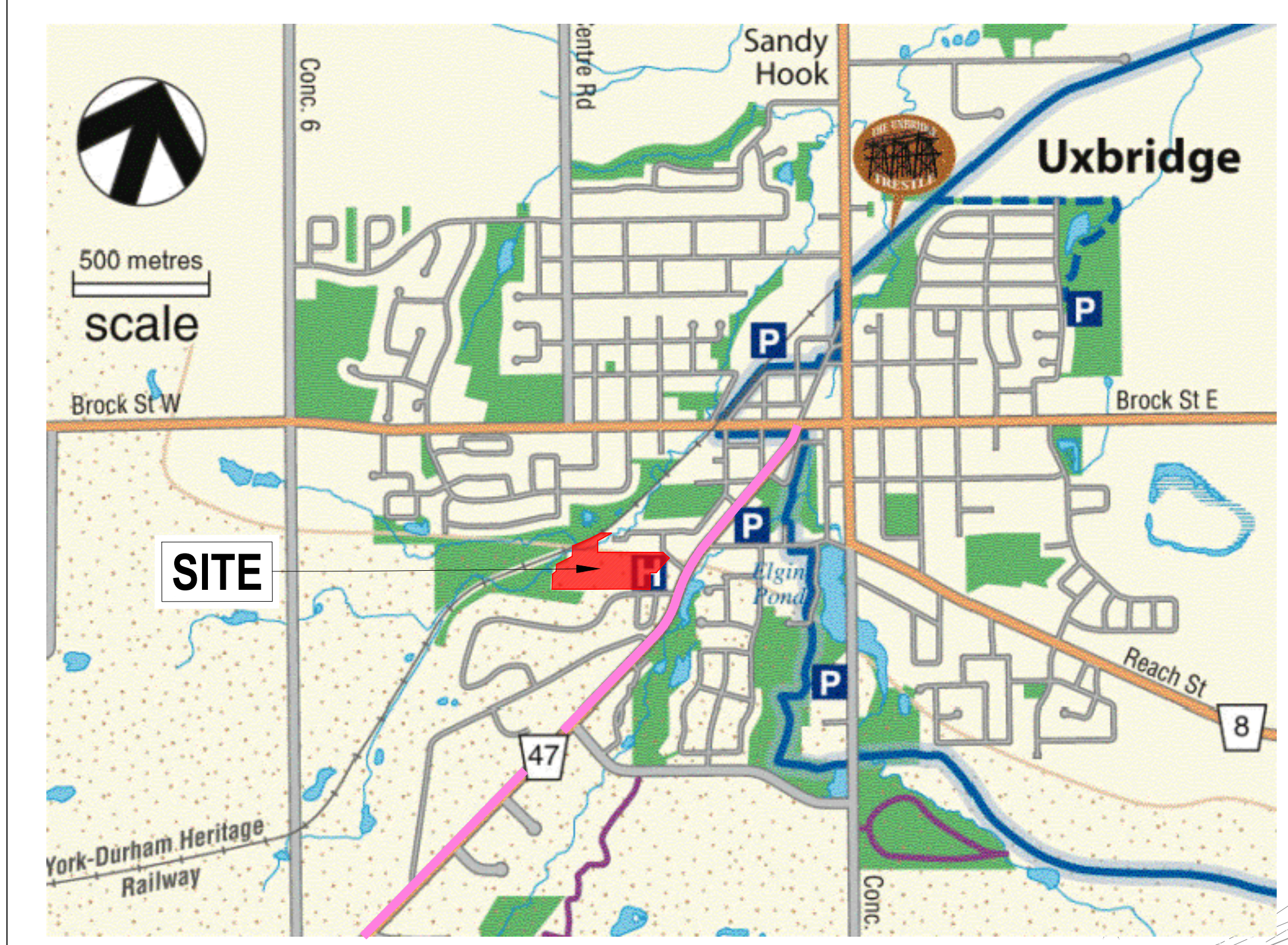

TOWN OF UXBRIDGE TRAIL SYSTEM - ACTIVE TRANSPORTATION PLAN

legend

- Trans Canada Trail
- Trans Canada Trail Access
- Oak Ridges Trail
- Countryside Preserve
- forest trail
- Municipal Parklands
- Provincial Lands
- East Duffins Headwaters
- Durham Region Forests
- Parking, Hospital
- Regional Road
- Oak Ridges Moraine
- wetland
- Planned and Proposed Regional Cycling Connection

PEDESTRIAN CIRCULATION NOTE:

PEDESTRIAN CIRCULATION PLAN SHOWING THE EXISTING TRAILS ADJACENT TO THE SITE. NO IMPACTS TO EXISTING TRAILS DURING OR POST CONSTRUCTION. ON-SITE PEDESTRIAN CIRCULATION CONNECTS TO LOCAL SIDEWALKS AT STREET FRONTAGES.

NOTE:
1. FOR THE LANDSCAPE DESIGN WITHIN THE PROPOSED LONG TERM CARE SCOPE OF WORK, REFER TO LONG TERM CARE LANDSCAPE DRAWINGS LP100 - LP220.

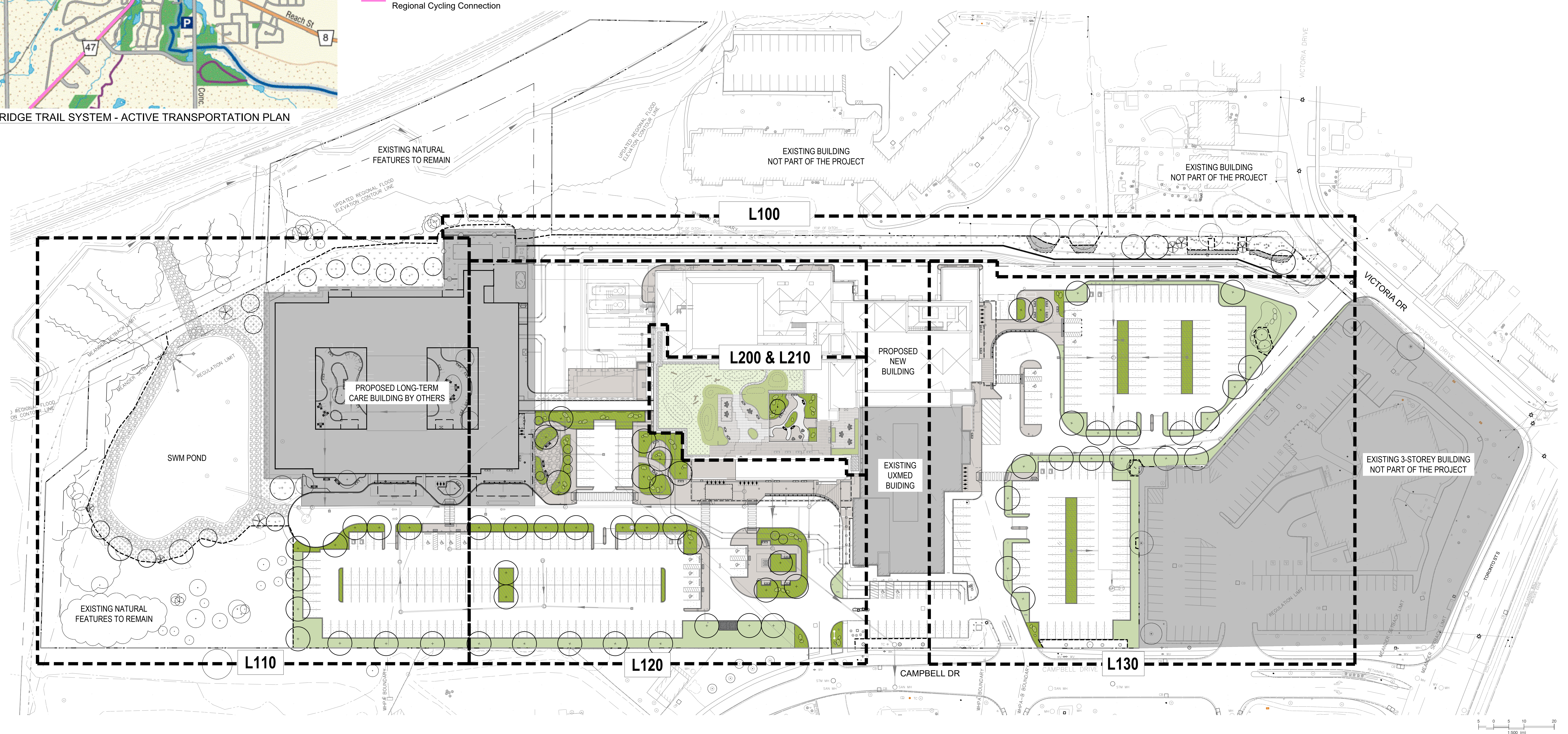

diamond schmitt
GSP group

GENERAL NOTES:

- DRAWINGS NOT TO BE USED FOR CONSTRUCTION UNLESS AUTHORIZED BY THE LANDSCAPE ARCHITECT
- CONTRACTOR SHALL REPORT ANY DISCREPANCIES BETWEEN THE DRAWINGS AND SITE CONDITIONS PRIOR TO COMMENCEMENT OF THE WORK
- ALL UTILITY LOCATES ARE THE RESPONSIBILITY OF THE CONTRACTOR. HAND IS WITHIN THE LIMITS. RECOMMENDED BY THE SERVICE UTILITY. UTILITY CONFLICTS WITH PROPOSED TREE LOCATIONS MUST BE REPORTED IMMEDIATELY TO THE LANDSCAPE ARCHITECT
- BASE DRAWING PROVIDED BY DIAMOND SCHMITT ARCHITECTS
- VEGETATION INVENTORY BY GSP GROUP INC.
- LANDSCAPE DRAWINGS SHOW ENGINEERING INFORMATION FOR DESIGN PURPOSES ONLY. DO NOT CONSTRUCT ENGINEERING WORKS FROM THESE DRAWINGS

NO.	DATE	DESCRIPTION
1	2024-04-01	Issued for Schematic Design Coding
2	2024-04-26	Issued for MCH Draft Submission
3	2024-05-02	Issued for Stage 2.1 Block Schematics
4	2024-07-12	Issued for Coordination
5	2024-07-31	Issued for 50% CD
6	2024-09-19	Issued for Site Plan Approval
7	2024-11-08	Issued for Site Plan Approval
8	2024-11-29	Issued for DD Coding
9	2024-12-13	Issued for Draft MCH Stage 2.2 Submission
10	2025-01-23	Issued for Stage 2.2 Sketch Plan
11	2025-01-30	Issued for 100% CD
12	2025-02-06	Issued for Site Plan Approval
13	2025-03-27	Issued for 50% CD
14	2025-04-17	Issued for 50% CD Coding
15	2025-06-12	Issued for Zoning Bylaw Amendment
16	2025-06-26	Issued for 90% CD
17	2025-08-11	Issued for SPA Resubmission
18	2025-09-30	Re-issued for Zoning Bylaw Amendment

Uxbridge Hospital
Oak Valley Health
PROJECT NO. 23175

Landscapes Site Plan
AS SHOWN
L100